

Air Raid Shelters

Do you know the names of the different types of shelters that kept people safe?

Anderson Shelters: About 3.7million of these shelters were built. They were designed to be small, cheap, and easy to construct in people’s gardens. They were constructed with 6 sheets of corrugated metal and built half under the ground. Earth was heaped on top of them. Six people could usually fit in one of these shelters.



Morrison Shelters: If you didn’t have a garden another option was a Morrison shelter. These shelters were 2meters long, 1.2meters wide and 0.75meters high. They had a mesh around the edges, and a mattress in the bottom. They were really strong. Two adults and 2 children would usually fit inside of this shelter. Lots of people used them as tables when not in use.



Public and work shelters: There were many public shelters in busy cities and towns. In London underground stations were used. In Newcastle, there was a public shelter in the Grainger Market, and the Victoria Tunnel which runs from the Great North Museum: Hancock down to Ouseburn. Lots of businesses had their own underground shelters, including the Co-operative at Blandford Square, which is now the Discovery Museum.

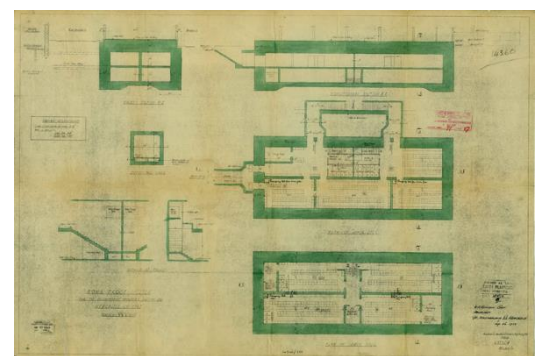

Can you make an air raid shelter out of junk materials? Make sure it is really strong and has enough room to fit a family in.